

Detail 1

Pos 5.11-1 Stoß HEM240

M.: 1:10

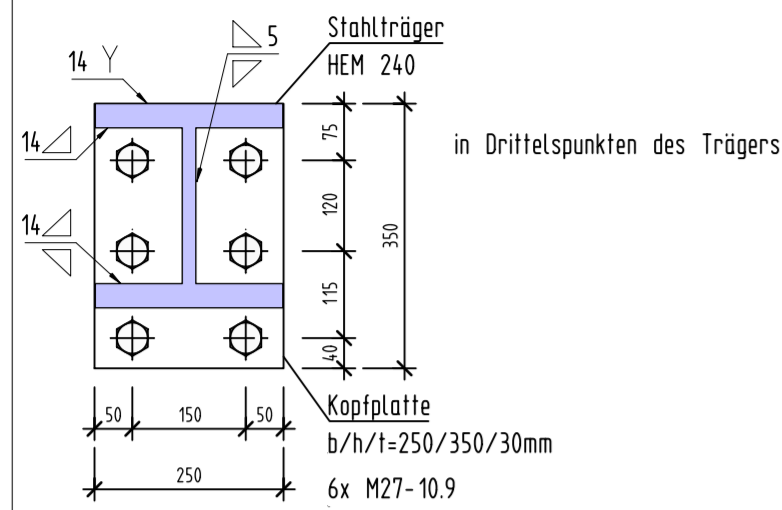

Detail 2

Pos 5.21-1 Stoß HEB240

M.: 1:10

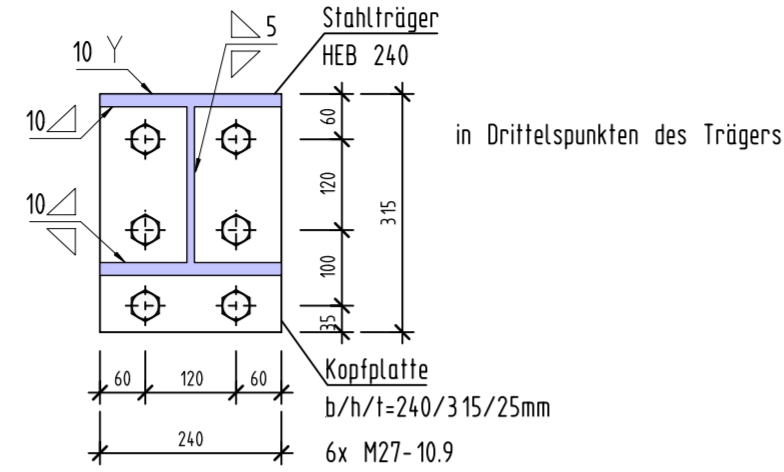

Detail 3

Pos 4.41-1 Stoß HEA240

M.: 1:10

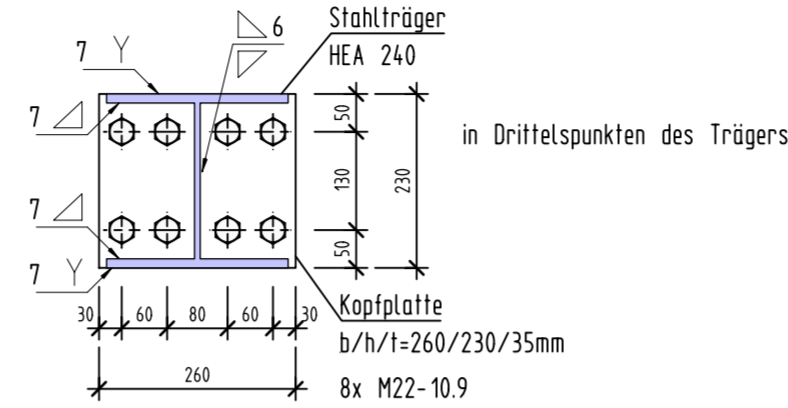

Detail 4

Pos 5.42-1 Stoß HEA220

M.: 1:10

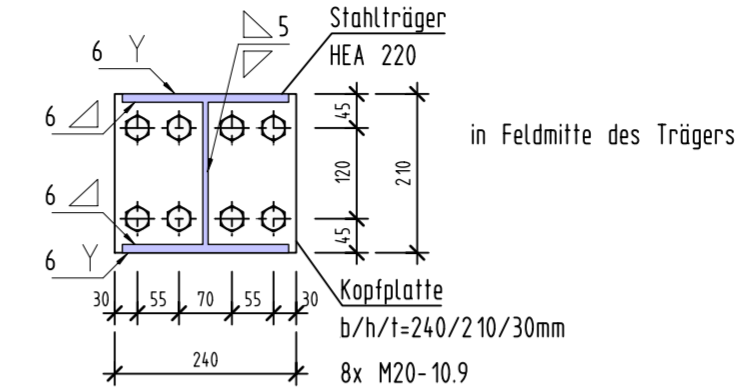

Detail 5

Pos 4.11-1 Stoß HEM220

M.: 1:10

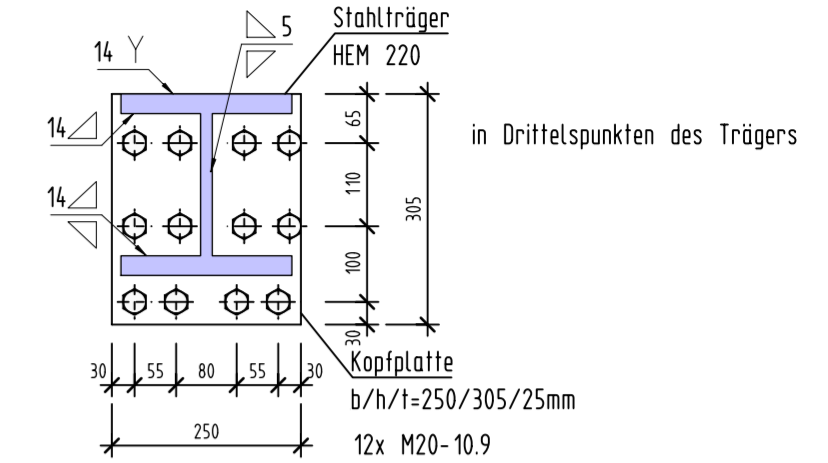

Detail 6

Pos 4.21-1 Stoß HEA 180

M.: 1:10

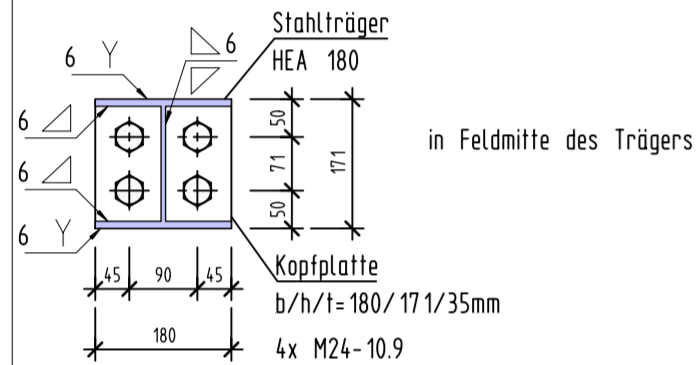

Detail 7

Pos 4.31-1 Stoß HEA200

M.: 1:10

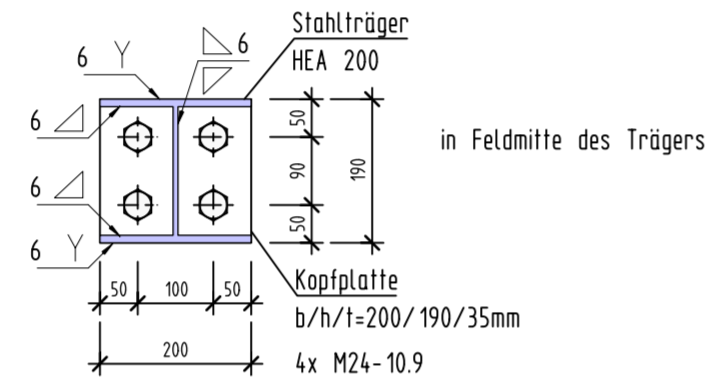

Detail 8

Pos 4.71-1 Stoß HEB260

M.: 1:10

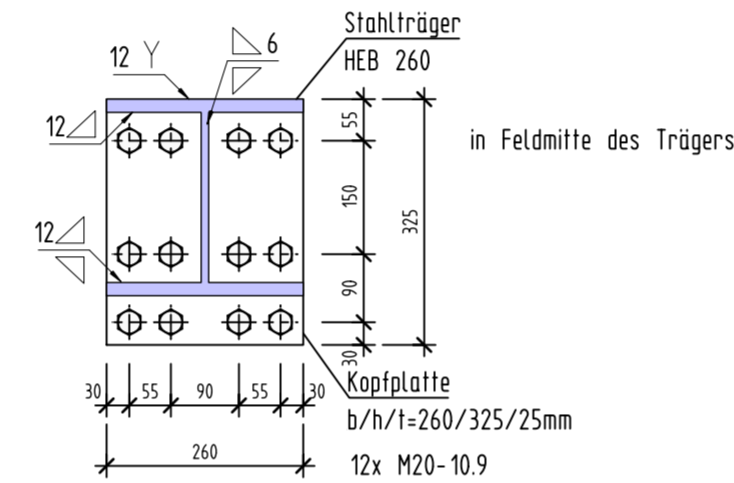

Detail 9

Pos E.21-1 Stoß HEB280

M.: 1:10

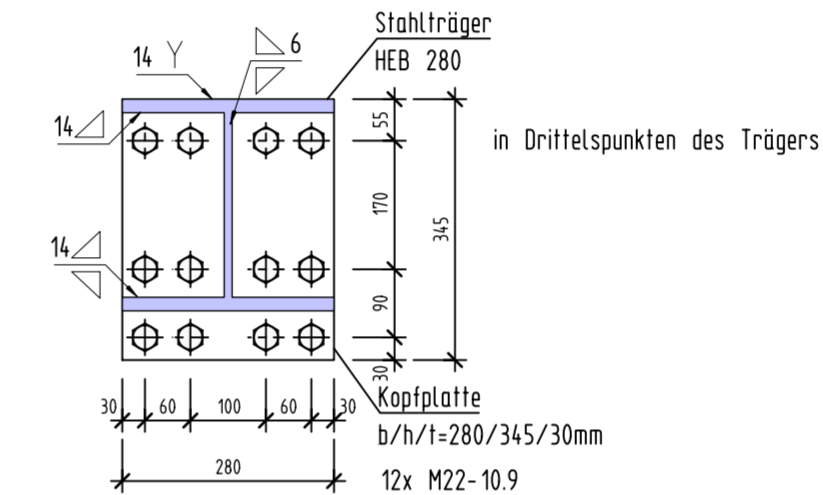

Detail 10

Pos 3.11-1 Stoß HEB220

M.: 1:10

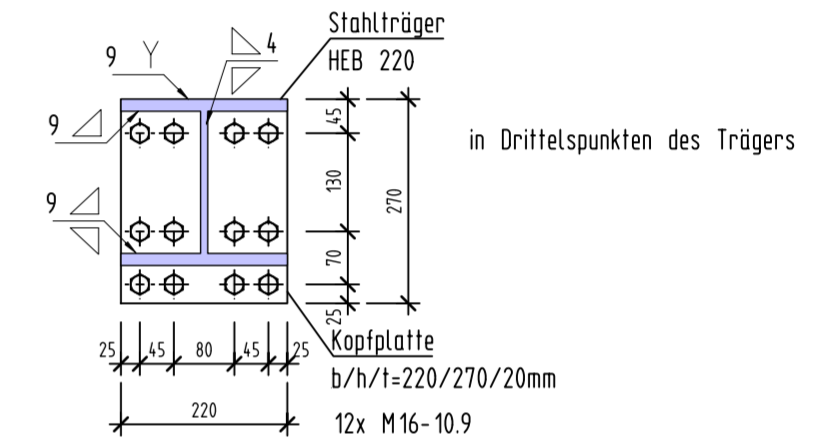

Detail 11

Pos 3.71-1 Stoß HEB450

M.: 1:10

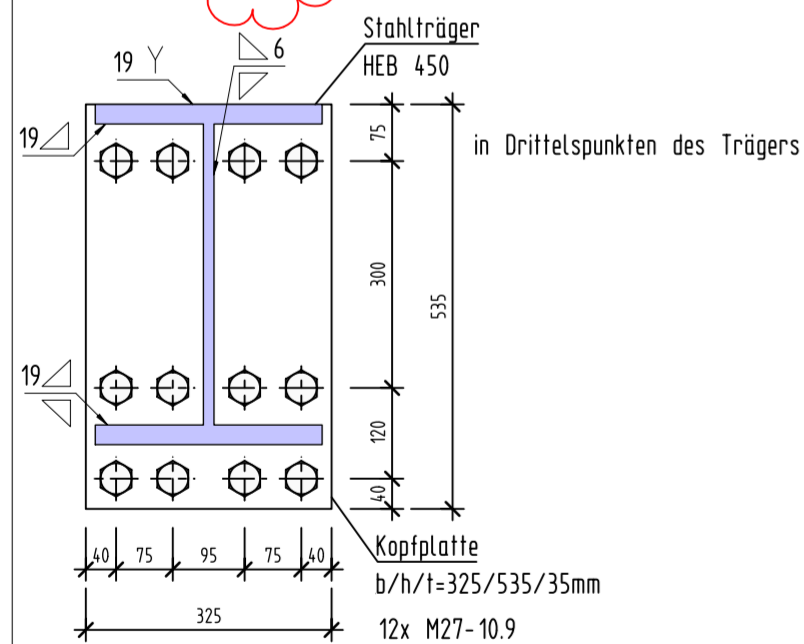

Detail 12

Pos E.91-1 Stoß HEM600

M.: 1:10

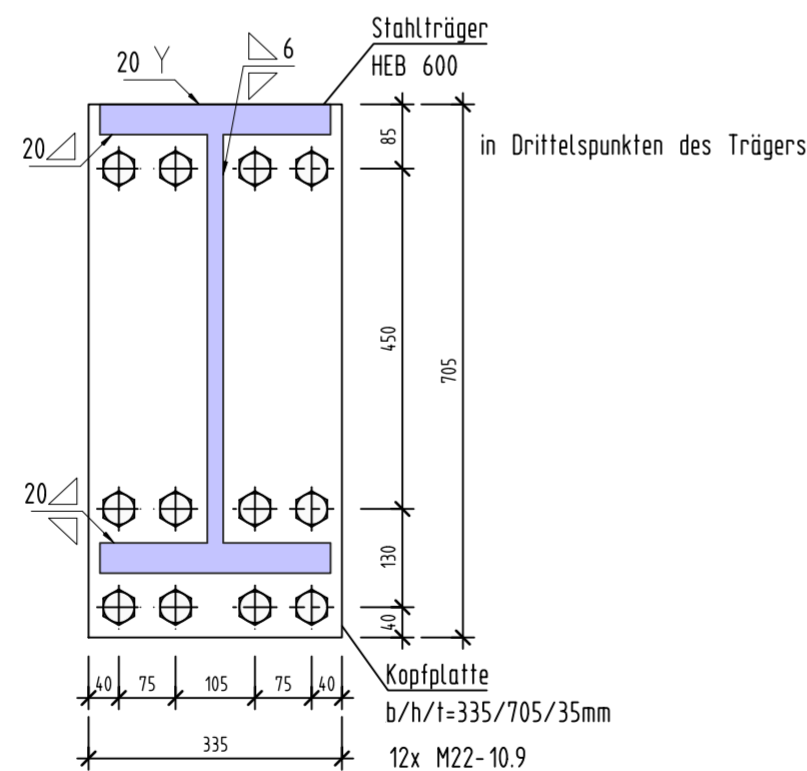

Detail 13

Pos E.11-1 Stoß HEB400

M.: 1:10

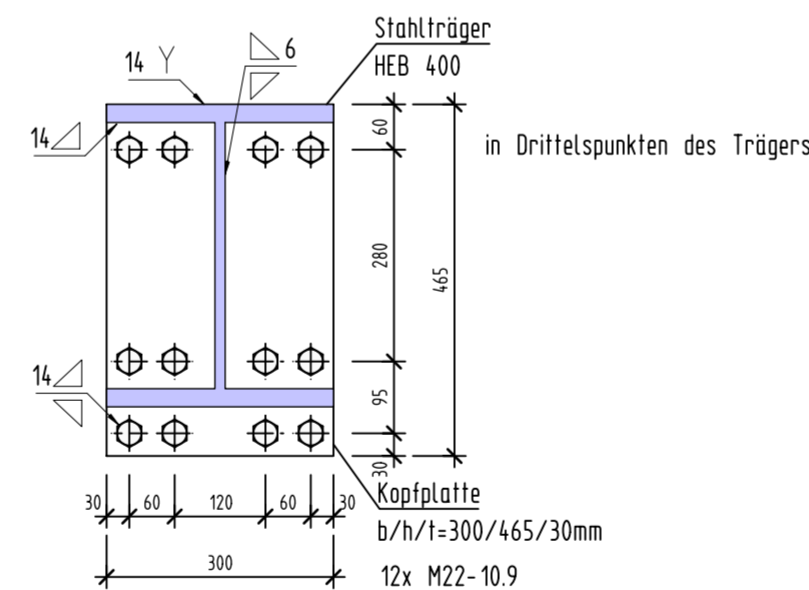

Detail 14

Pos 3.101-1 Stoß HEB200

M.: 1:10

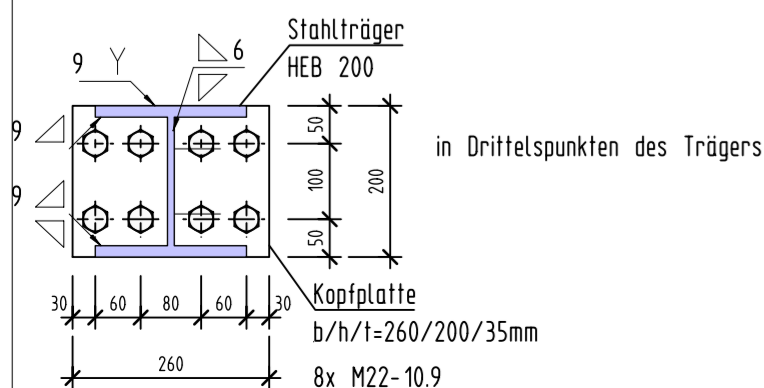

a	Bezeichnung Detail 11	18.07.2023	vs
Index:	Änderungen:	Datum:	Name:

Bauvorhaben:
Sanierung und Erweiterung Otto-Pankok-Schule
Von-Bock-Strasse 81
45468 Mülheim an der Ruhr

Bauherr:
ImmobilienService der Stadt Mülheim an der Ruhr
Hans-Boeckler-Platz 5
45468 Mülheim an der Ruhr

Architekt:
Hütténes GmbH Architekten
Reichspräsidentenstraße 21 - 25
45470 Mülheim an der Ruhr

Planverfasser:



Zweigertstraße 14
45130 Essen
[Fon] 0201-8718120
[Fax] 0201-871812100
[email] buero@rw-ingenieure.de
[web] www.rw-ingenieure.de

Bauteil: Detailplan Trägerstöße			
Gezeichnet: vs	Maßstab: 1:10	Projekt-Nr.: T-161123	Blatt-Nr.: P09
Datum: 10.07.2023	Blattgröße: DIN A2		Index: a